

LEGEND:

- BOUNDARY LINE
- - - CENTERLINE
- RIGHT OF WAY LINE
- SECTION LINE
- - - S. LINE
- - - EASEMENT LINE
- - - STORM DRAIN
- - - GAS LINE
- - - OVERHEAD ELECTRIC
- - - SEWER LINE
- - - WATER LINE
- - - IRON PIN FOUND
- - - IRON PIN SET
- - - BENCHMARK
- - - UTILITY POLE
- - - U. P. W/LIGHT
- - - GAS METER
- - - GAS VALVE
- - - SAN SEWER MANHOLE
- - - WATER METER
- - - FIRE HYDRANT
- - - WATER VALVE
- - - ELECTRIC RISER
- - - PROPOSED SIGN
- - - EXIST. CENTER OF PAVEMENT
- - - 911 ADDRESS
- - - QUAD CROSSING

CURVE TABLE

CURVE	LENGTH	RADIUS
C1	18.53	25.00
C2	68.19	50.00
C3	48.65	50.00
C4	37.55	50.00
C5	18.69	25.00
C6	18.69	25.00
C7	23.51	50.00
C8	48.34	50.00
C9	46.82	50.00
C10	33.78	50.00
C11	18.59	25.00
C12	47.78	25.00
C13	46.62	30.00
C14	18.69	25.00
C15	10.86	50.00
C16	70.19	50.00
C17	50.03	50.00
C18	33.92	50.00
C19	18.69	25.00
C20	47.63	30.00
C21	3.40	25.00
C22	18.59	25.00
C23	61.37	50.00
C24	57.05	50.00
C25	33.79	50.00
C26	18.69	25.00
C27	46.47	30.00
C28	31.48	20.00
C29	47.02	30.00
C30	47.78	30.00
C31	31.35	20.00
C32	47.63	30.00
C33	46.47	30.00
C34	47.63	30.00
C35	46.62	30.00

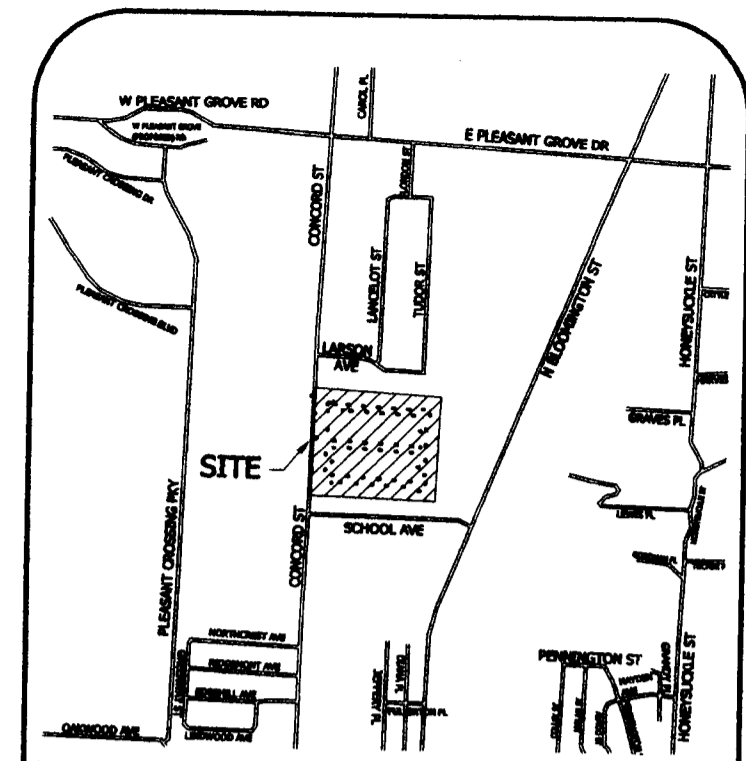

VICINITY MAP
SCALE 1"=2000'
LATITUDE: 36°16'27" N
LONGITUDE: 94°08'19" W

CERTIFICATE OF AUTHORIZATION
PACE AND BELL, INC.
No. 1596
Brent D. Gage, Licensed Professional Surveyor
Benton County, Arkansas
Book/Ps: 2009/236
Town/Cashier: CASH/TRAHER
04/30/2009 3:16:13PM
Tran: 71912
Total Fees: \$15.00
Book 2009 Page 236
Recorded in the Above
PLAT Book & Page
04/30/2009

STATE OF ARKANSAS
COUNTY OF BENTON
CITY OF LOWELL

FINAL PLAT OF EDINBURGH SUBDIVISION

DATE OF LAST REVISION:

PACE & BELL, INC.
P.O. BOX 8
CAVE SPRINGS, AR 72718
PHONE: (479) 203-7179

DRAWN BY: DGA/CEB	SCALE: 1" = 100'
FIELD CREW: NAS/CEB	DWG: EDINBURGH FINAL PLAT
CHECKED BY: CEB/DGA/NAS	DATE: 07-02-08
SHEET 1 OF 2	

FINAL PLAT OF EDINBURGH SUBDIVISION
(SHEET 1 OF 2)

ALL LOTS HAVE A 7 FOOT SETBACK ON SIDE LOT LINES UNLESS NOTED OTHERWISE
NOTE: 5/ 8" REBAR WITH CAP STAMPED "D. ATWELL AR 1452" SET AT ALL LOT CORNERS UNLESS NOTED OTHERWISE.
STATE PLAT CODE: 500-19N-30W-0-35-210-04-1452

SURVEY DESCRIPTION:
PART OF THE NORTHEAST 1/4 OF THE SOUTHEAST 1/4 OF SECTION 35, TOWNSHIP 19 NORTH, RANGE 30 WEST, BENTON COUNTY, ARKANSAS, BEING MORE PARTICULARLY DESCRIBED AS FOLLOWS:
COMMENCING AT THE SOUTHWEST CORNER OF SAID NE1/4 OF THE SE1/4; THENCE N02°27'08"E 164.78 FEET TO THE POINT OF BEGINNING; THENCE CONTINUING N02°27'08"E 1136.07 FEET; THENCE S86°23'19"E 1324.47 FEET; THENCE S02°28'57"W 806.49 FEET TO A FOUND IRON PIN; THENCE S02°31'39"W 129.83 FEET TO A FOUND IRON PIN; THENCE S03°06'12"W 159.55 FEET TO A FOUND IRON PIN; THENCE N88°07'32"W 593.01 FEET TO A FOUND IRON PIN; THENCE N88°08'03"W 726.51 FEET TO THE POINT OF BEGINNING, CONTAINING 33.88 ACRES, MORE OR LESS, SUBJECT TO ANY EASEMENTS, COVENANTS OR RESTRICTIONS OF RECORD OR FACT.

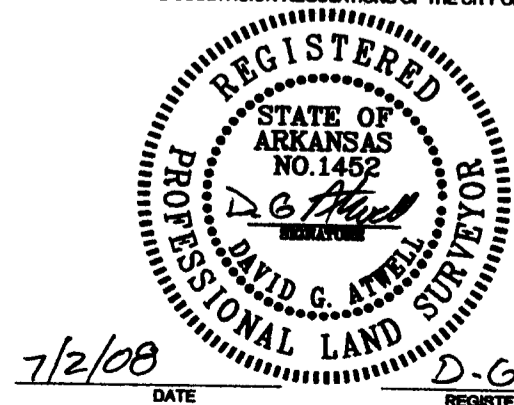

CERTIFICATE OF SURVEY AND ACCURACY:
I HEREBY CERTIFY THAT THE PLAN SHOWN AND DESCRIBED ON THIS PLAT IS A TRUE AND CORRECT SURVEY AND THAT THE MONUMENTS HAVE BEEN PLACED AS STATED AND AS REQUIRED BY THE SUBDIVISION REGULATIONS OF THE CITY OF LOWELL.

7/2/08 DATE REGISTERED LAND SURVEYOR 1452